

# Assembly & Fitting Manual

December 2006

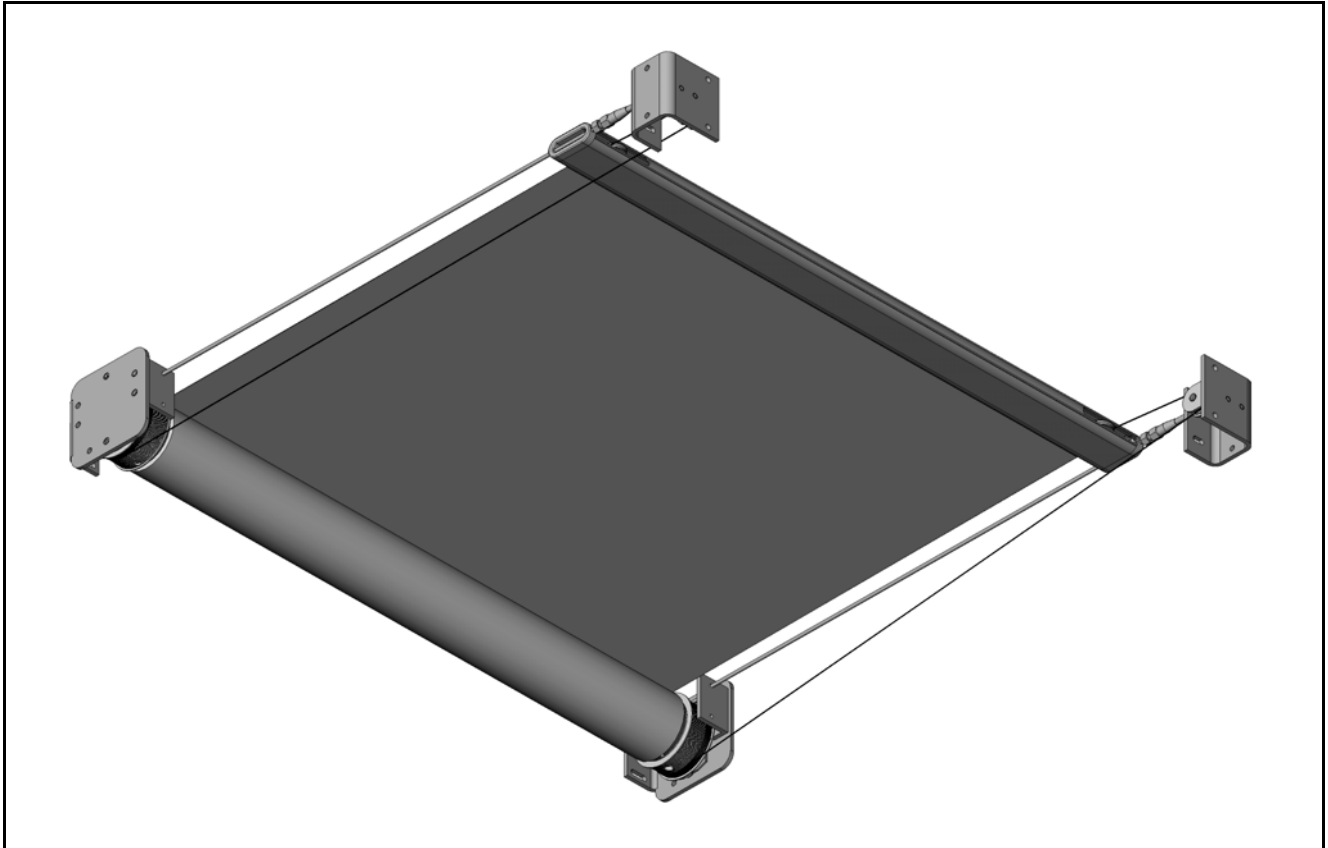

Silent Gliss® Skylight Shading System 8600

SGGB Version January 2007

All printed and electronically distributed copies are uncontrolled copies

## Content

Product Information .....	3
Assembling .....	6
Fitting / Maintenance / Ordering .....	17



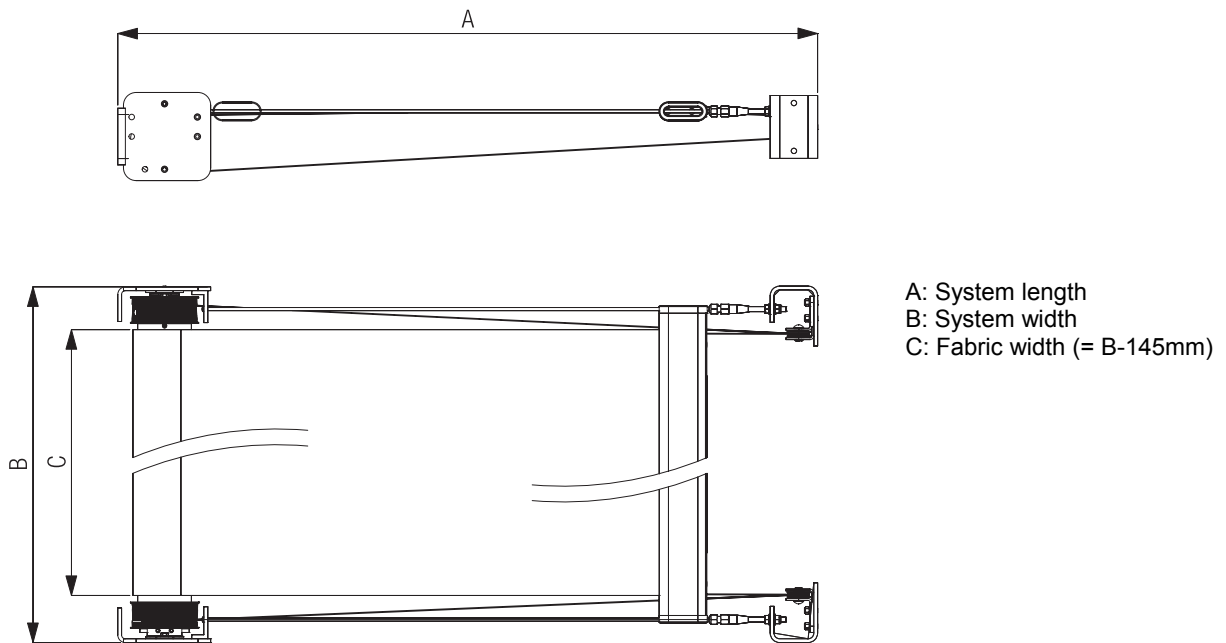

## Product Information

### Outline Drawing / Measures

How to measure:

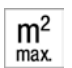

### System Dimension:

				
4.0 m (B) of	Up to length 3 m = 87 cm Over length of 3 m = 108 cm	6.50 m (A)	18 sqm (max.)	30 kg (system weight without fabric) fabric weight: 450 gr/sqm)

### Loading Chart:

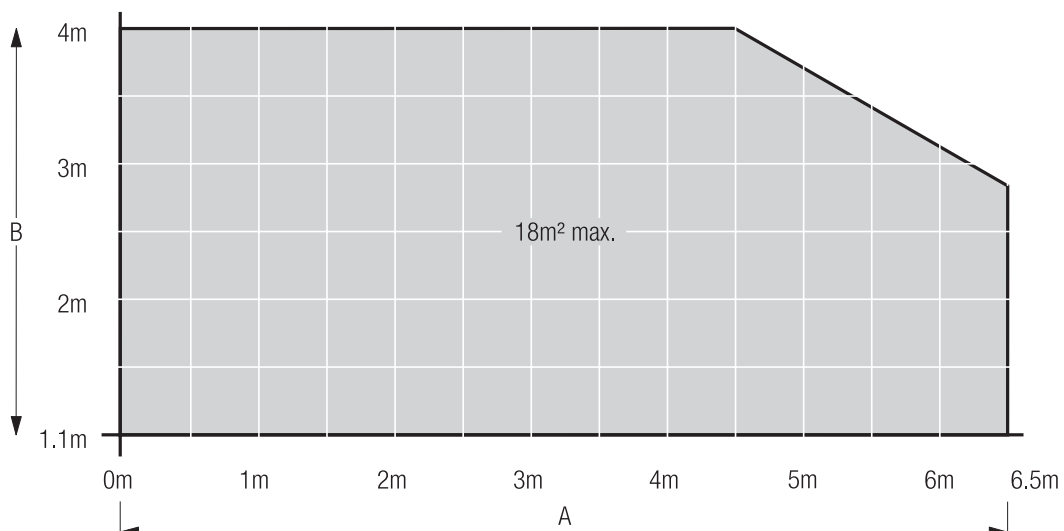

All printed and electronically distributed copies are uncontrolled copies

## System Configurations

Single system:

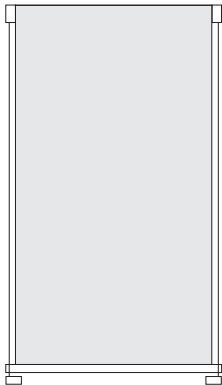

Multiple system (each system requires its own motor):

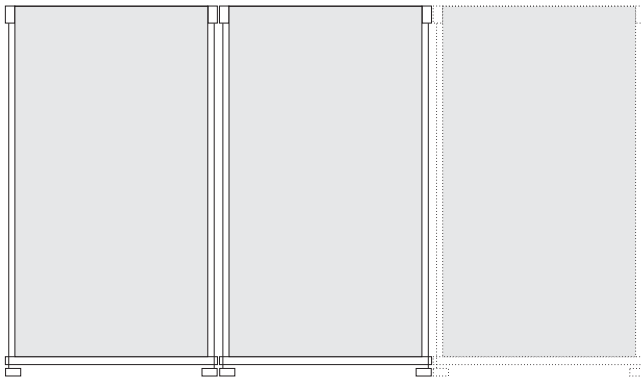

Installation:



Vertical section of longitudinal axis (A)

A) Installation possible at any angle (0-360°) along the center line of the roller tube

Vertical section of diagonal axis (B+C)

B) System can only be installed horizontally

C) System cannot be installed inclined

Motor position: Standard side is left! Motor side right can also be ordered but with some extra costs because of a special spring:

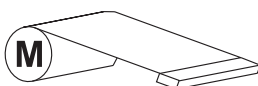

Standard: Motor on the left side!

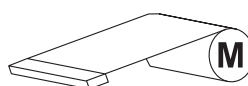

Motor on the right side

## Technical Data Motor:

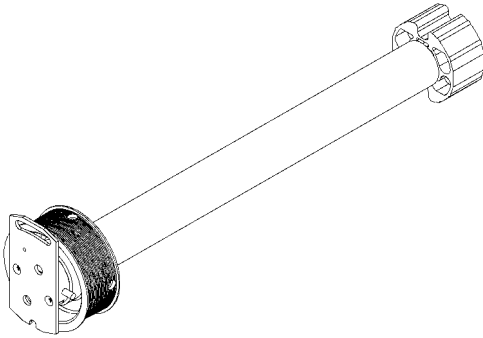

Voltage: 120V / 230V  
 Torque: 15Nm / 15Nm  
 Frequency: 60Hz / 50Hz  
 Power: 130W / 140W  
 Current: 1.1A / 0.65A  
 Speed: 18rpm / 17rpm

Thermal overload protection  
 Mechanical end stop  
 The motor will be supplied with 2.5 m cable (white) without plug

## Wiring:

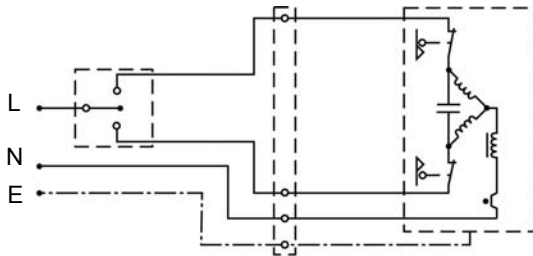

## Operating Methods:

Fixed wall switch

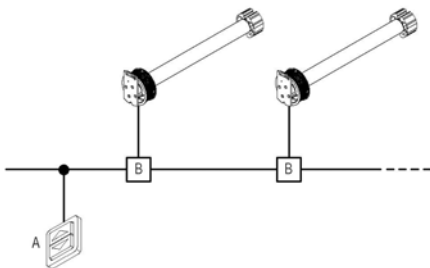

A: Wall Switch  
 B: Relays

Remote Control

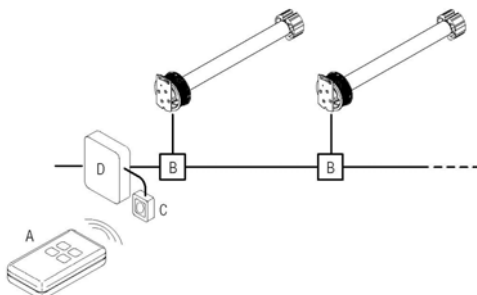

A: Transmitter  
 B: Relays  
 C: Receiver-eye  
 D: Receiver

## Assembling

### Overview Wall Fix:

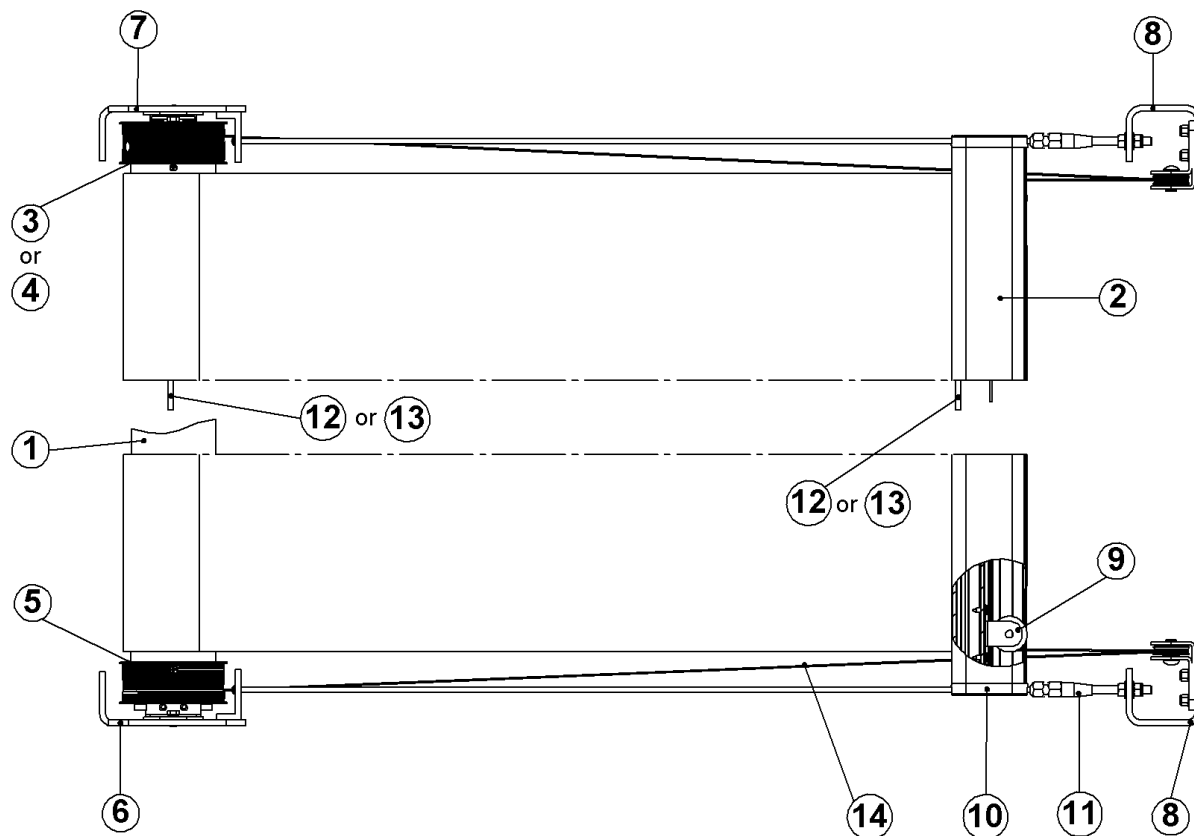

### Parts-List Wall Fix:

1	Tension wire 1.5mm	14		8619
2	Fabric insert 6mm	13		8618
2	Fabric insert 5mm	12		8617
2	Wire guide set	11		8616
2	Bottom bar end cap set	10		8615
2	Bottom bar pulley set	9		8614
2	Pulley bracket wall left / right	8		8613
1	Roller bracket wall right	7		8612
1	Roller bracket wall left	6		8611
1	Motor set	5		8605
1	Spring set long	4		8604
1	Spring set short	3		8603
1	Profile	2	AlMgSi 0.5	8602
1	Profile	1	AlMgSi 0.5	8601
Stück Piece	Titel	Pos. Pos.	Werkstoff Material	Teilenummer part number



## System preparation

- 1 Fabric making up: The fabric should have a 25 mm pocket (welded) on both sides

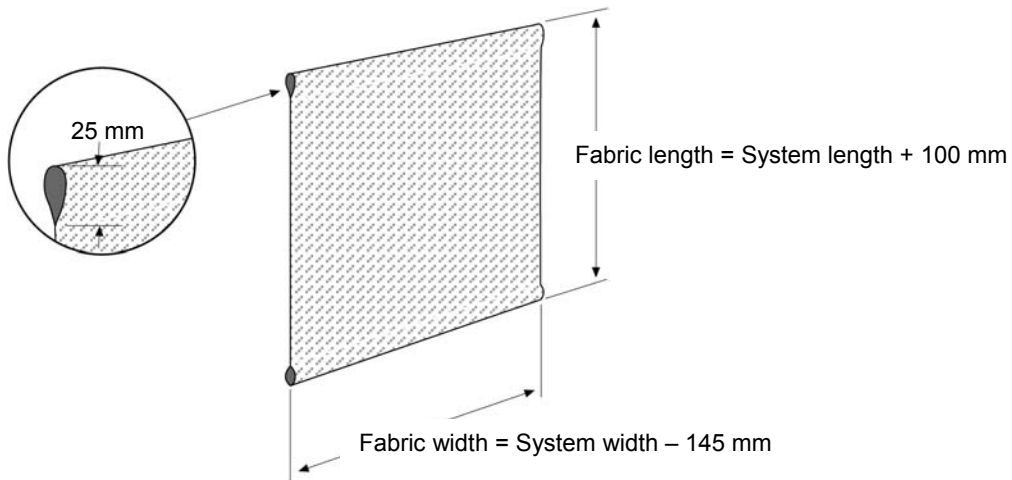

- 2 Remove the spring from the tube

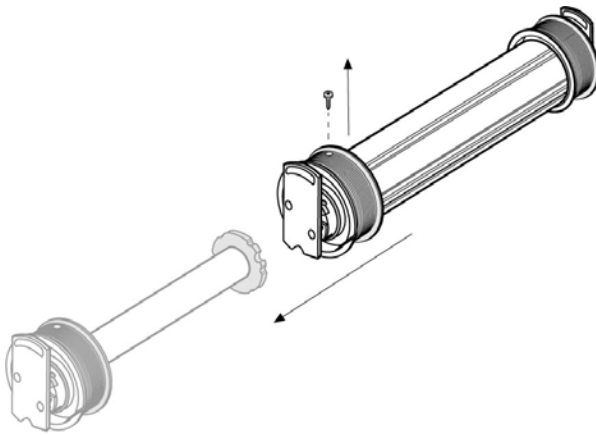

- 3 Insert the fabric into the groove of the tube with 5 or 6 mm rod. Then fix the spring back into the tube

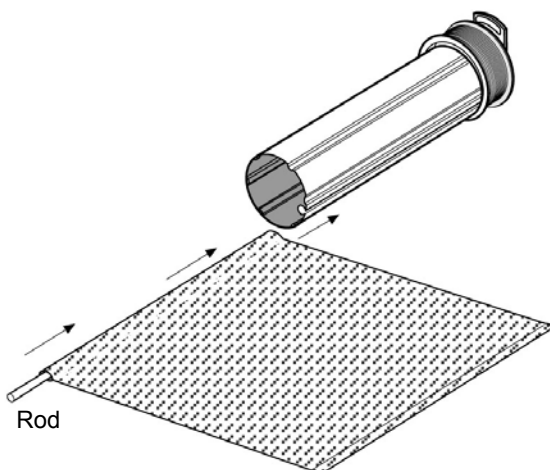



- 4 Wind the fabric onto the roller. **Important** – standard system – motor on the left as shown. Therefore the system will always be delivered with the motor positioned on the left as a standard. When ordering systems with motor positioned on the right it will be charged at extra costs due to the special spring required.

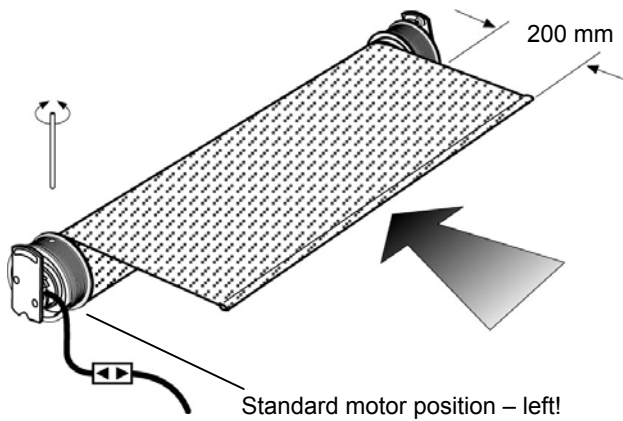

- 5 Insert the fabric into the groove of the bottom bar with 5 or 6 mm rod.

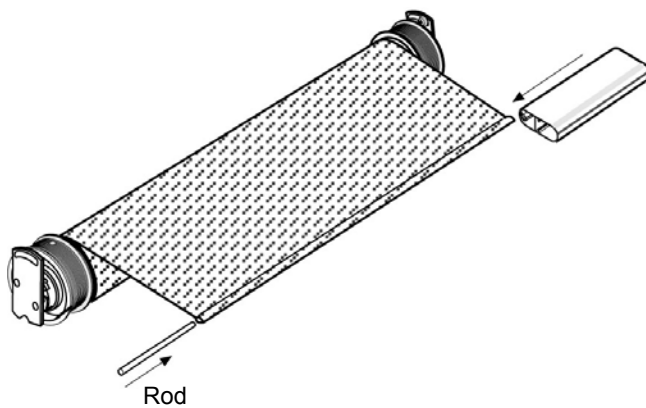

## 6a Fixing of brackets for Wall-/Back Fix

Measure Drawing:

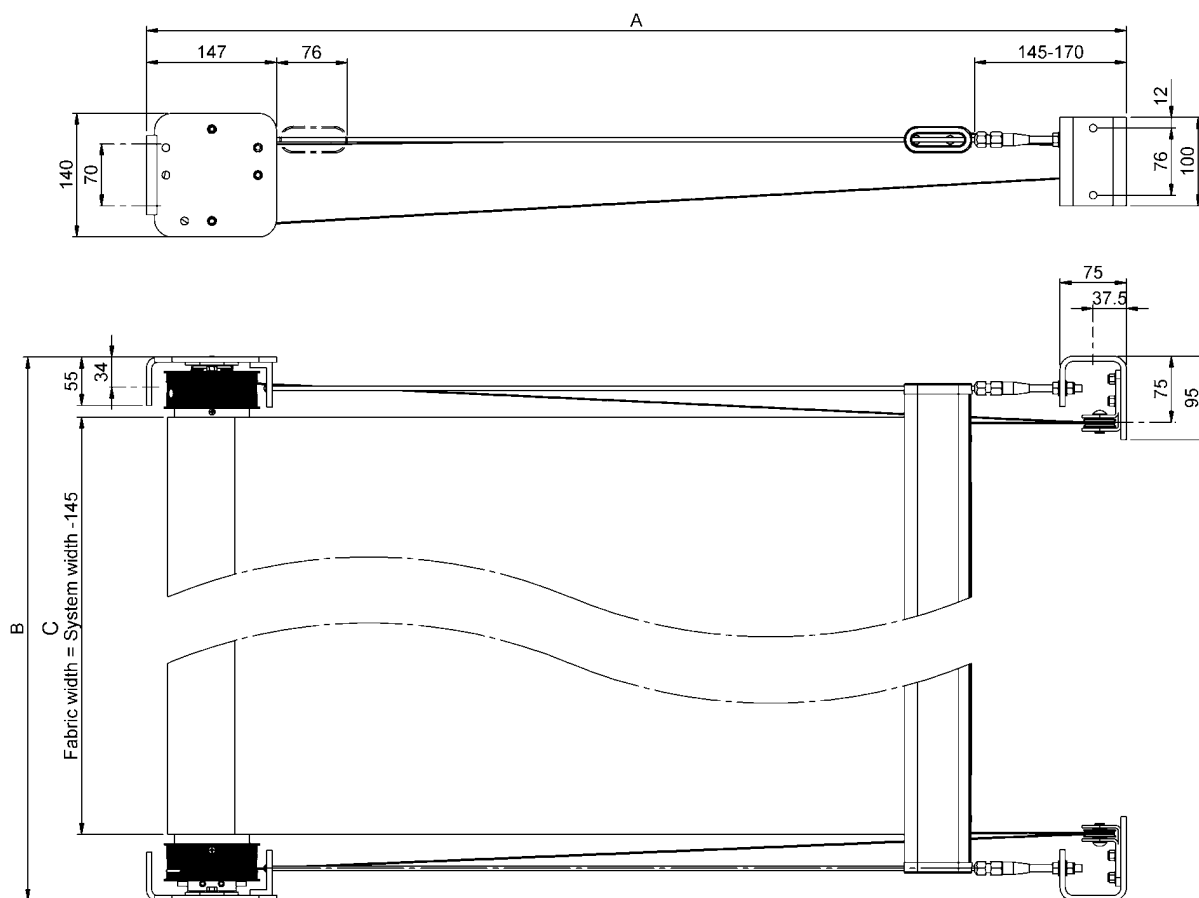

Note: Brackets can either be fixed onto the sidewall or onto the back wall or even mixed.

Bracket sets for Wall-/Back fix:

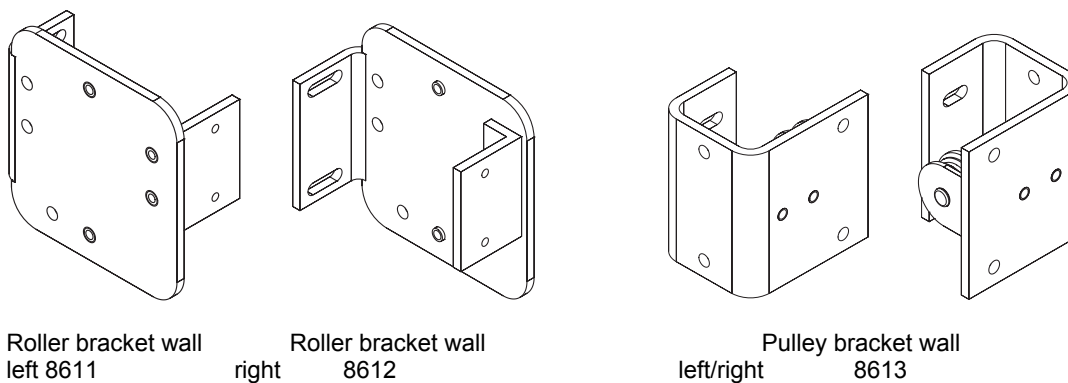

Note:

System weight (without fabric): max. 30 kg  
Pulling force per bracket: typical 100 kg

## 6b Fixing of brackets for Ceiling Fix

Measure Drawing:

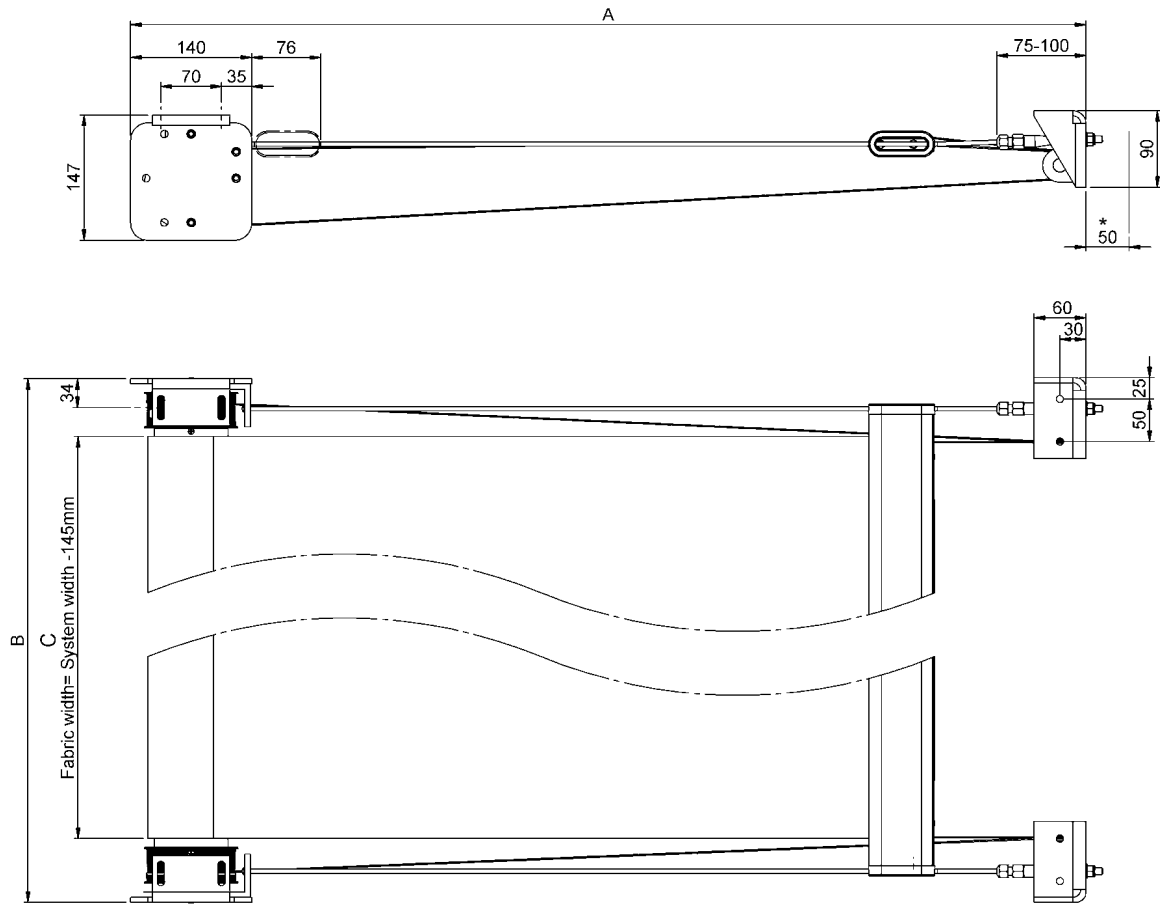

\* Note: Ceiling fix return pulley requires 50 mm back clearance!

Bracket sets for Ceiling fix:

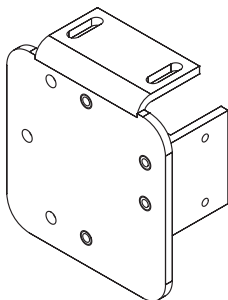

Roller bracket ceiling  
left 8606

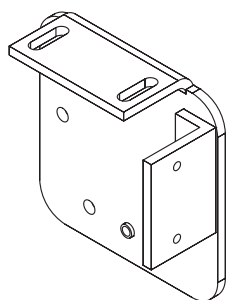

Roller bracket ceiling  
right 8607

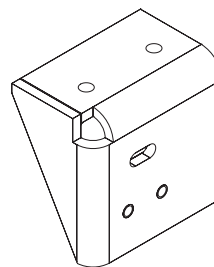

Pulley bracket ceiling  
left 8608

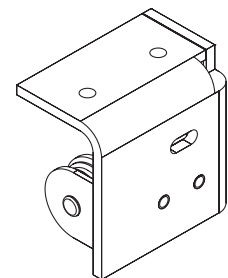

Pulley bracket ceiling  
right 8609

Note:

System weight (without fabric):

max. 30 kg

Pulling force per bracket:

typical 100 kg

7 Fit the roller blind between the mounting brackets

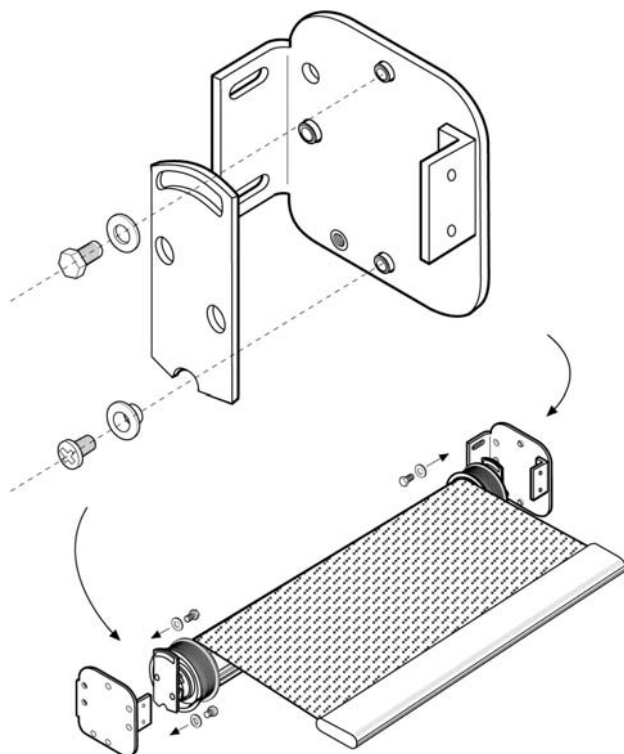

8 Pull the tension cable through the bottom bar and fit the end caps

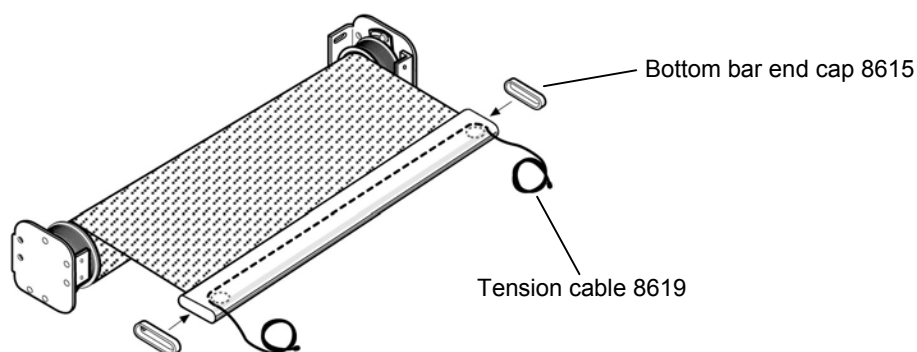

9 Pull the tension cable through both return pulleys and back to the cable drums

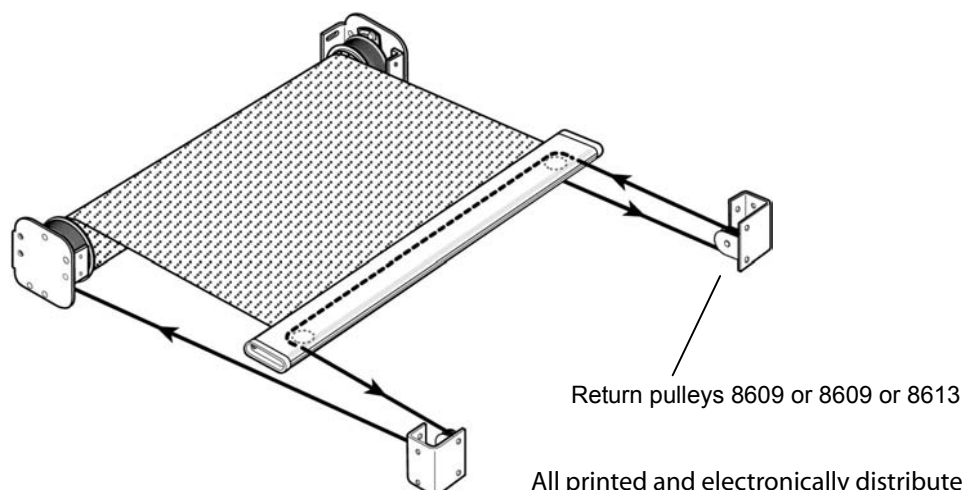

## 10 Fixing of the tension cable onto the drums

- Wind 2 turns onto the drum on motor side
- Insert the cable into the drum and through the locking device on motor side and check the cable will not pull out
- Check the correct position of the cable on the grooves
- Do the same on the drum on the spring side and leave about 500 mm slack

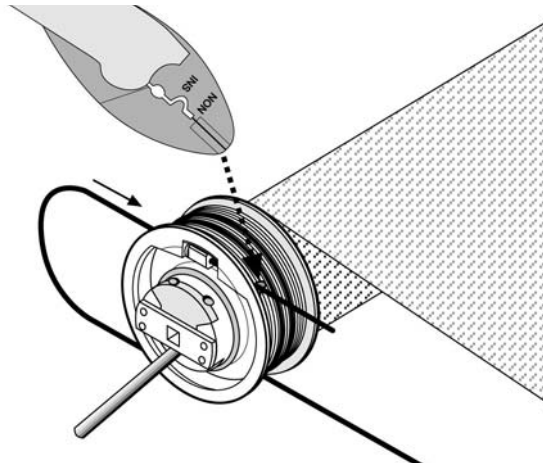

## 11 Cut off excess tension cable and adjust light tension by using the tensioning tool (provided together with the blind)

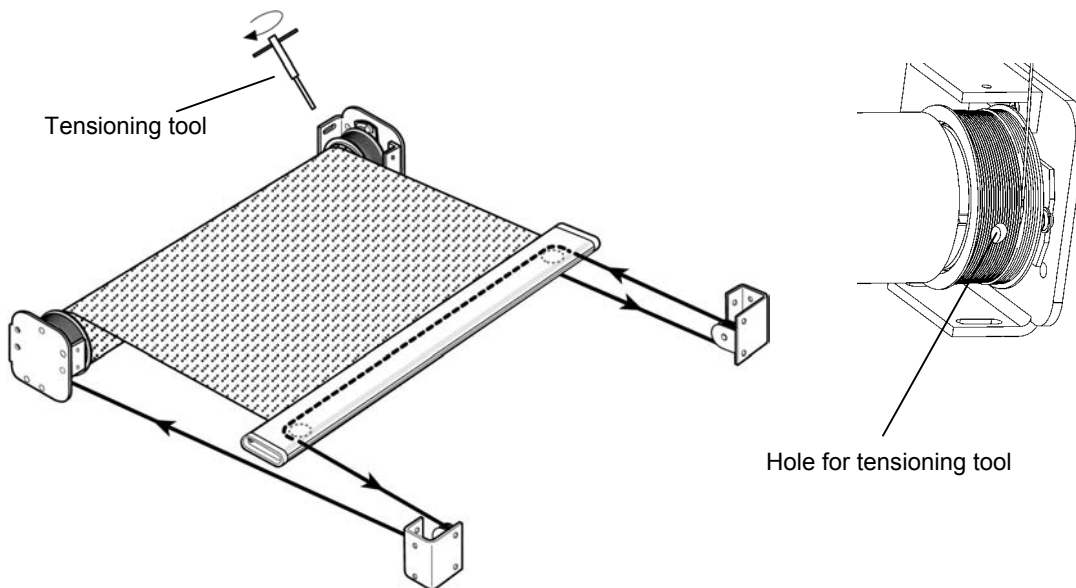

## 12 Insert the end of the guide wire through the upper mounting bracket hole

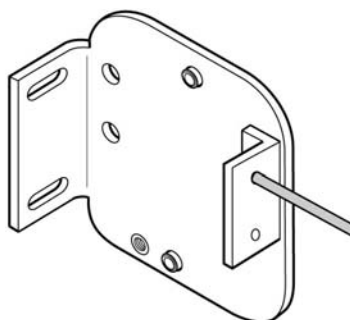

- 13 Pass the guide wire through the bottom bar end cap

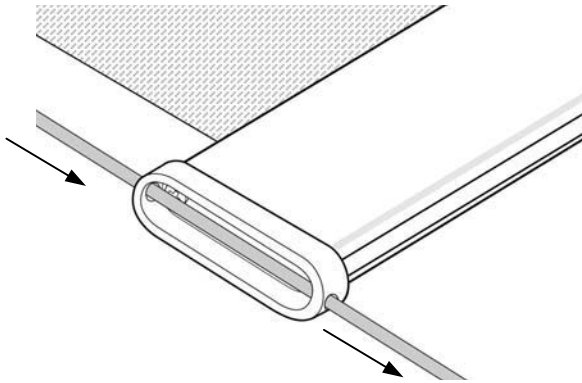

- 14 Cut the wire to length and attach it to the return pulley bracket. Then tension the guide wire (Refer to the wire manufacturer's instructions enclosed)

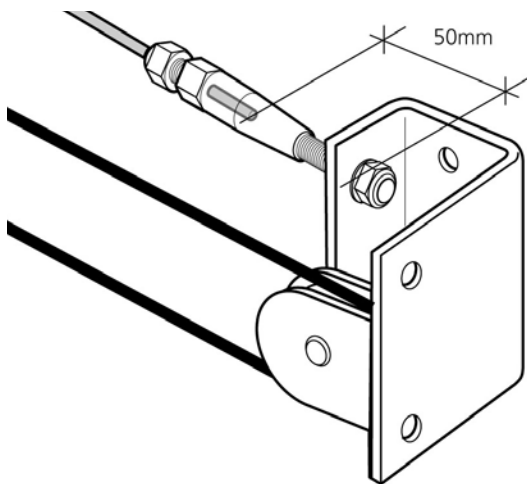

- 15 Finish fixed guide wire

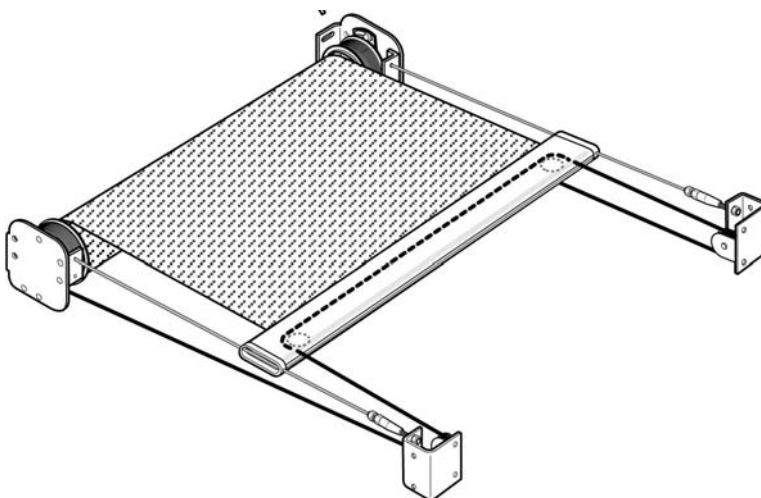

- 16 Check before the final commissioning that the tension cable sits correctly on all pulleys

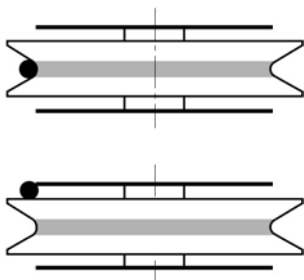

- 17 Set the limit positions (Refer to the motor manufacturer's instructions enclosed)

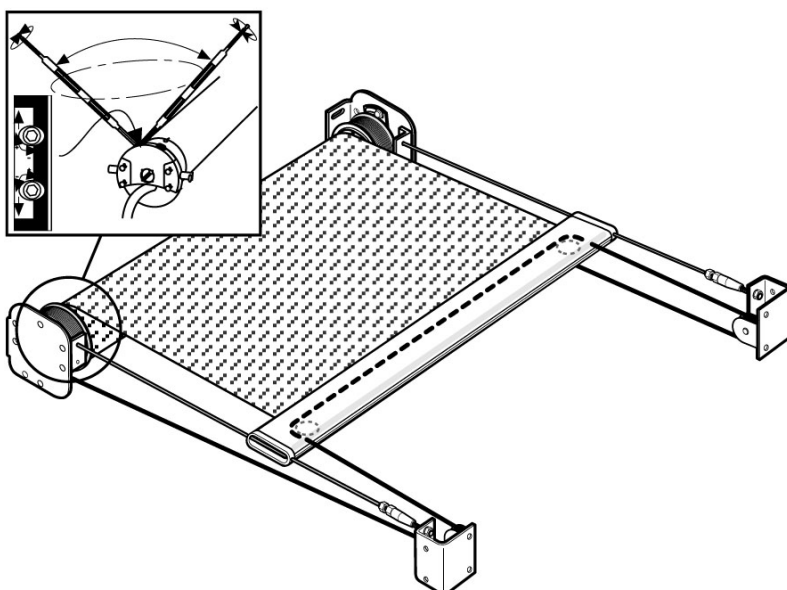

- 18 Adjust the final tension to the blind. 10 to 20 turns according to the system size

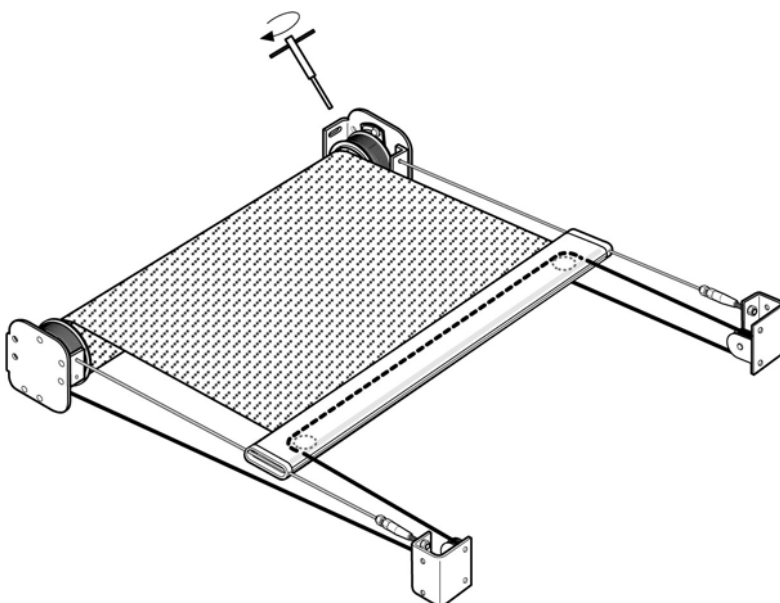

- 19 Track the blind using the built-in swivel plates both sides

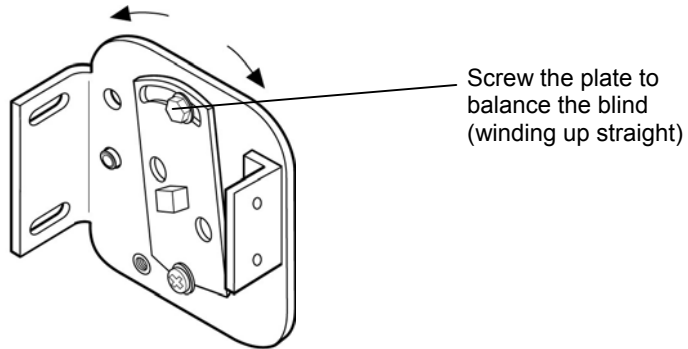

- 20 Finish fitted system

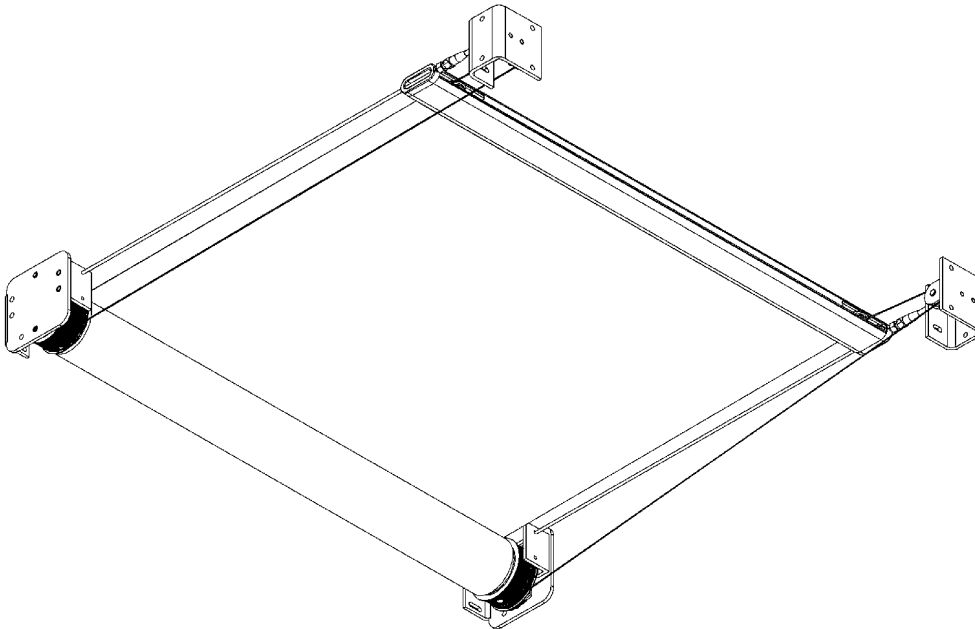



## Fitting / Maintenance / Ordering

### Fitting Options

#### Ceiling fitting with roller- and pulley brackets left and right

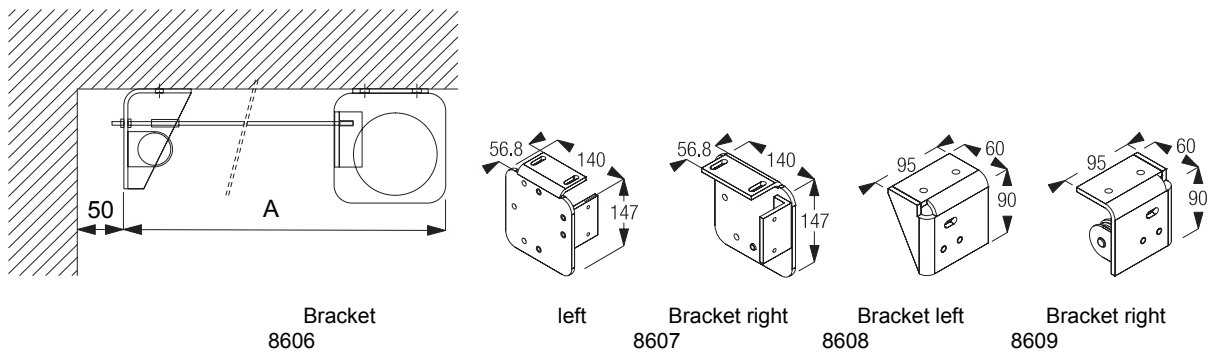

#### Wall fitting with roller brackets left and right and pulley bracket left/right

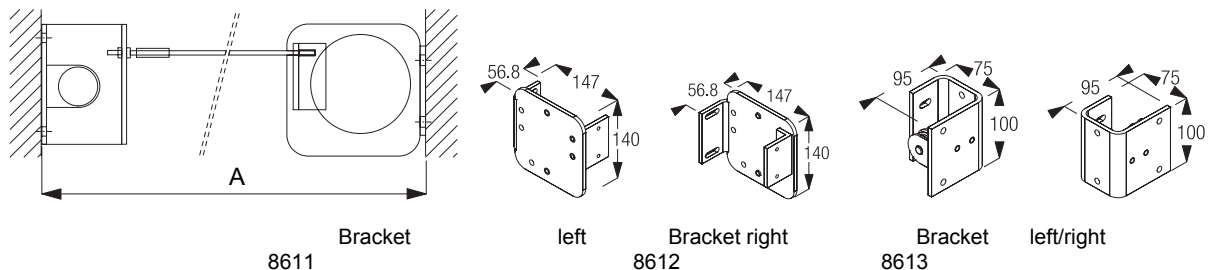

### Maintenance

The tension system contains no serviceable parts. Where required, replacement components should be sought from the supplier of the equipment.

A regular 6 monthly inspection of the blind system is recommended:

#### **Visual inspection:**

Check for the fabric damage, foreign objects that would impede the operation of the blind, tension cable wear or damage and free running of all pulleys within tension system.

#### **Fixings:**

Ensure all fixings are tight.

#### **Operate blind via test switch:**

Ensure correct fabric tracking and stopping position of fabric. Adjust as necessary.

#### **Electrics:**

Check all wiring for loose connectors or damaged cabling. Where fitted, check operation of any automatic devices such as wind over-ride.

The above is meant as an indication of the maintenance requirements of the system. For further details or queries, please refer to your original supplier.

