

Silent Gliss®

Panel Glide System Fitting Instructions

WARNING Parents should realise that children could accidentally strangle in window blind cords. Keep the cords out of the reach of children using cord tidy device.

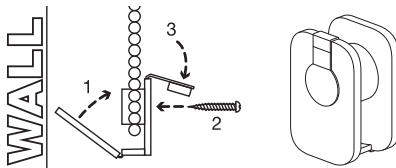

FACE/WALL FITTING INSTRUCTIONS

① Refer to your original records for the height you plan to have the track fitted.

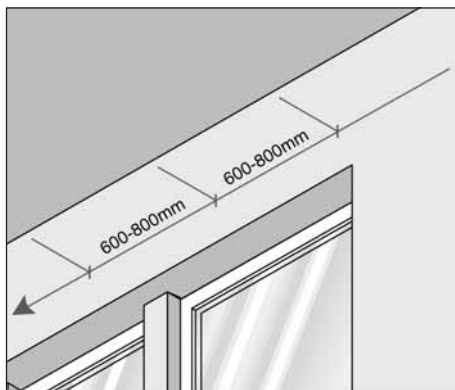

② Draw a straight line along the top of the wall where the track is to go and mark on this the position of the brackets. Each end bracket should be no more than 10cm from the ends of the track and each subsequent bracket should be spaced equally apart at 60-80cm intervals.

③ Drill holes into the wall at the centre position of the slots on the brackets. This will ensure a 1cm adjustment up and down if required. Screw the brackets onto the wall using rawl plugs as appropriate.

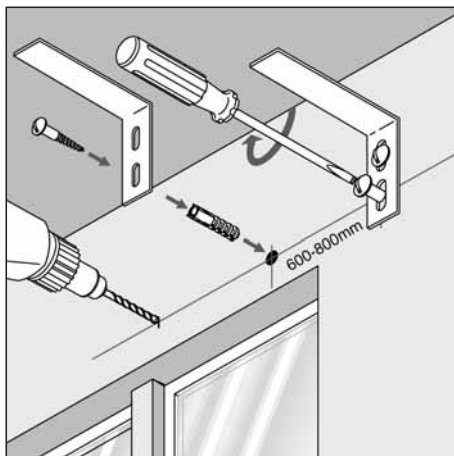

Face/Wall Fitting Instructions continued

- ④ Rotate the locking clamps to the position shown and put the track in place, ensuring the Velcro® on the carriers faces the room.
- N.B. For combination systems to make up 6 or 7 channel tracks always fit the front (roomside) track first. The track with the cord will always be at the rear (when cord operated).
- In some cases the rear clamps and tracks will have to be installed after the front track has been fixed into position.

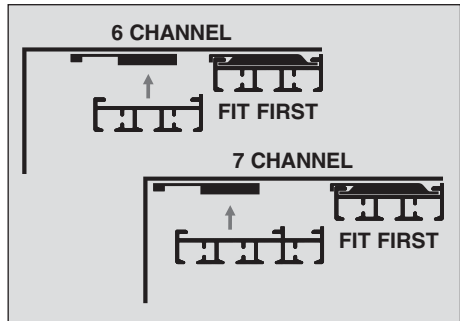

- ⑤ With the track in place on top of the brackets rotate each of the locking clamps until they touch the back of the track, starting with the centre bracket. It may be necessary to gently tap the clamps with a light hammer to lock them into place.

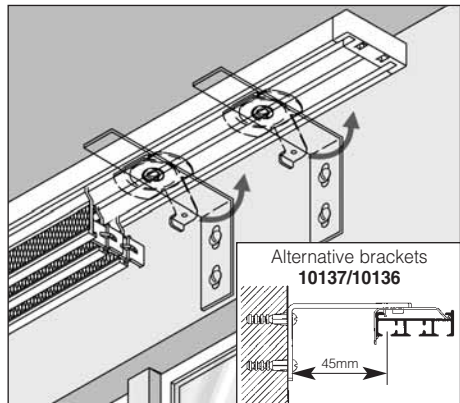

- ⑥ Operate the cords if cord operated to ensure that the separate carriers pick up one another so that they move in sequence. Should one connection between carriers miss, simply clip back into place.
- ⑦ Hang the fabric panels onto each of the carriers using the Velcro® tape. Ensure that the fabric is smoothed along the full length of the carrier.
- ⑧ Insert the aluminium weight into the bottom hem of the fabric.

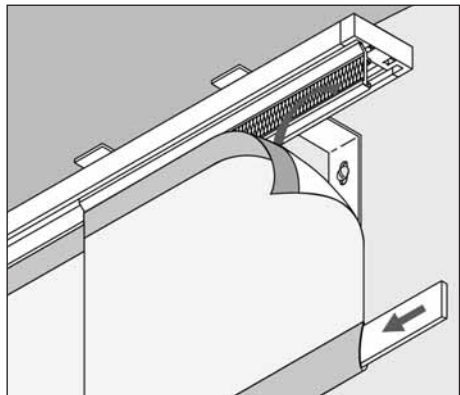

Ceiling Fitting Instructions

CEILING FITTING INSTRUCTIONS

- 1 Refer to your original records of where your track is to go.

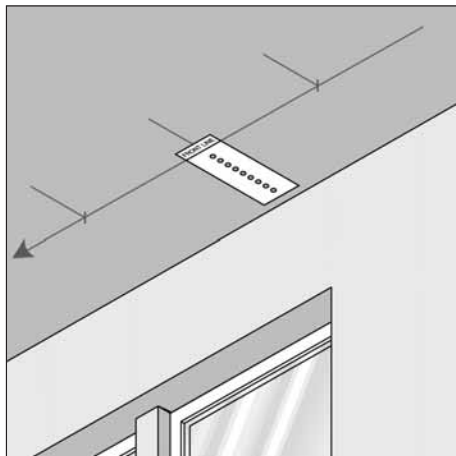

- 2 A template is supplied which shows the correct drill positions for your track. The FRONT LINE on the template refers to the position of the front of the track facing into the room. Draw a straight line along the ceiling marking the FRONT LINE of the track, ensuring clearance of doorhandles, sills etc is maintained along the full length.

- 3 Mark along this line the position of the brackets. Each end bracket should be 10cm from the ends of the track and each subsequent bracket should be spaced equally apart at 60-80cm intervals.

- 4 Using the template mark the drill holes indicated for each bracket using a pencil.

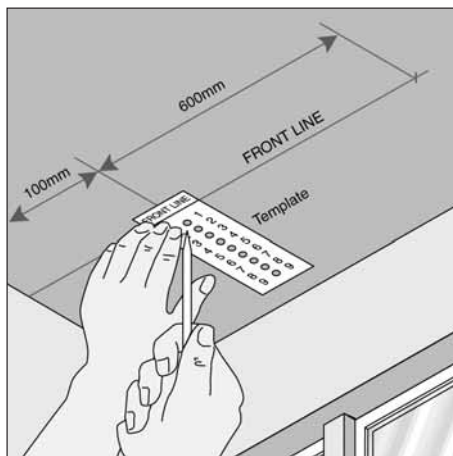

Ceiling Fitting Instructions continued

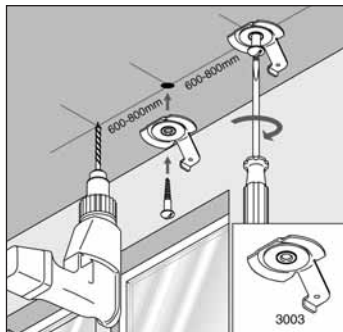

(3004 for use with 2 channel 10122 profile.)

- 5 Screw the clamps flat side to the ceiling, at the points marked. Fix until clamps are secure but can still be easily rotated, leaving the tail pointing to the wall.

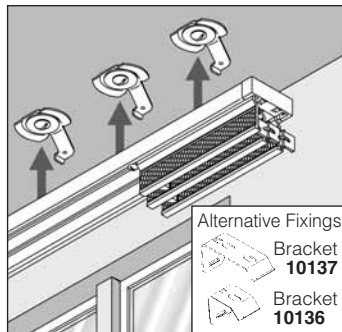

Alternative Fixings
Bracket 10137
Bracket 10136

- 6 Offer the track up to the brackets. Start at the centre and rotate locking clamps until they touch the back of the track. Depending on your fixing you may need to gently tap the clamps with a light hammer to lock into place. Move along the track until all the clamps are locked.

NB: For combination systems to make up 6 or 7 channel tracks always fit the front (roomside) clamps and track first. The track with the cord will always be at the rear.

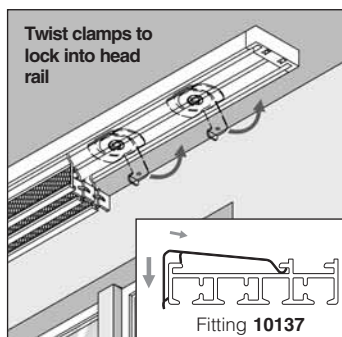

Twist clamps to lock into head rail

Fitting 10137

- 7 Operate the cords to ensure that the separate carriers pick up one another so that they move in sequence. Should one connection between carriers miss simply clip back into place.

- 8 Hang the fabric panels onto each of the desired carriers using the Velcro® tape. Ensure that the fabric is smoothed along the full length of the carrier.

- 9 Insert the aluminium weight into the bottom hem of the fabric.

